

Operator's Manual 6075 Fried Food Holder



WARNING: To reduce the risk of injury, the user must read and understand this operator's manual before using this Equipment.

**SAVE THIS OPERATOR'S MANUAL
FOR FUTURE REFERENCE.**

For **Parts and Warranty Service** call:



PartsTOWN
Your order's always up

Give us a call! (800) 438-8898

Personal service and same-day
shipping until 7pm EST



This document includes:

- before installation instructions
- shipping damage instructions
- important safety instructions
- site preparation and installation
- operating instructions
- cleaning instructions
- warranty statement



6075 FRIED FOOD HOLDER

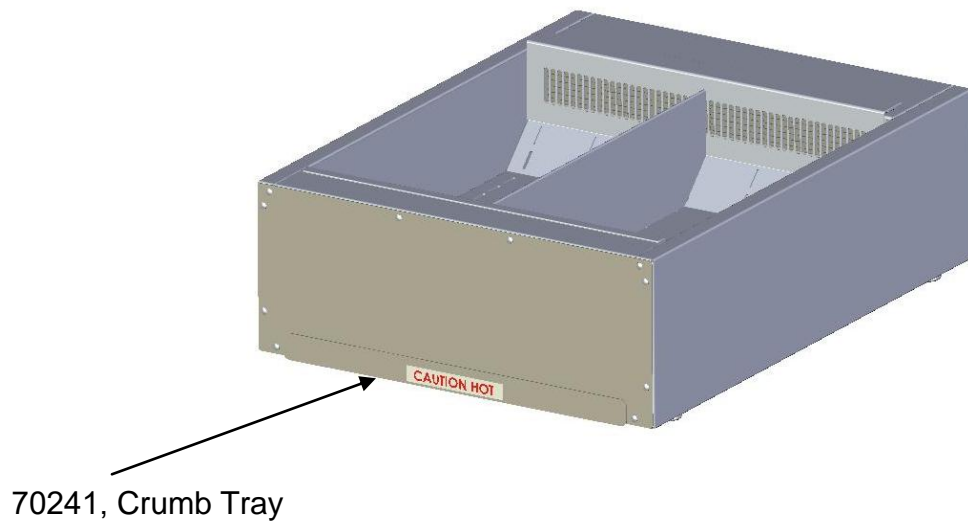
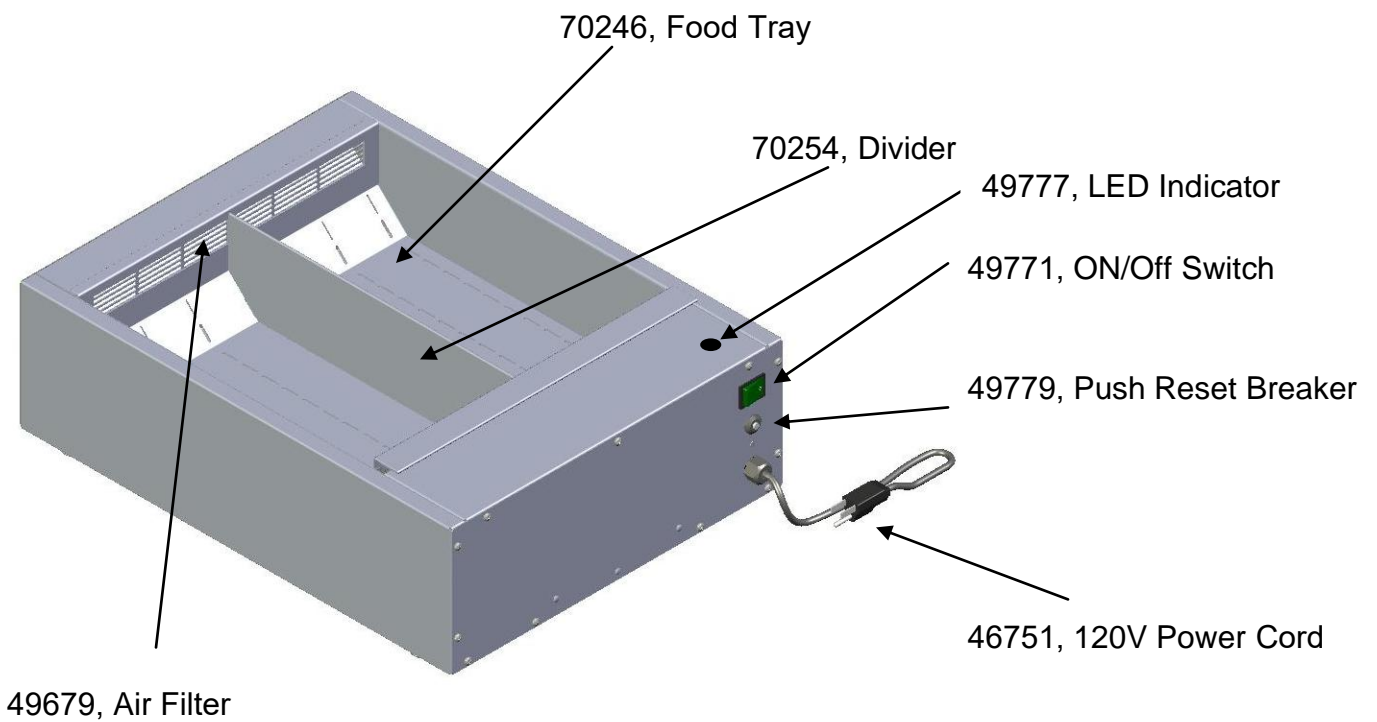

TABLE OF CONTENTS

Safety Symbol Section	Page 3
Before Installation	Page 4
Shipping Damage Instructions	Page 4
Important Safety Rules	Page 5
Extension Cord Instructions	Page 7
Site Preparation and Installation	Page 8
Specifications for 6075	Page 9
Clearances Requirements for 6075	Page 10
Operating Instructions	Page 11
Cleaning Instructions	Page 11
Troubleshooting Guide	Page 12
Parts and Warranty Service	Page 13
Parts Identification	Page 14
Limited One-Year Warranty	Page 15

SAFETY SYMBOL SECTION

The following signal words and meanings are intended to explain the level of risks associated with this Equipment. The ANSI standard safety symbols are:



DANGER: Indicates an imminently hazardous situation, which, if not avoided, will result in death or serious injury.



WARNING: Indicates a potentially hazardous situation, which, if not avoided, may result in death or serious injury.



CAUTION: Indicates a potentially hazardous situation, which, if not avoided, may result in minor or moderate injury.

To avoid serious personal injury, do not attempt to use this Equipment until you have read thoroughly and understand completely the operator's manual. Save this operator's manual and review frequently for continuing safe operation and instructing others who may use this Equipment.

BEFORE INSTALLATION

NOTE: Upon receipt of your Equipment, immediately uncrate, unpack and inspect for potentially concealed shipping damage. If your Equipment is found to be damaged, save all packing materials and contact your delivery carrier immediately. Refer to “Shipping Damage Claim Instructions” on the right for instructions. Failure to follow these instructions will negate NEMCO's or your ability to file claims and receive compensation for shipping damage.

This manual contains important safety and installation – operation instructions. Require all operators to read this manual before using this Equipment. Refer to these instructions frequently. Failure to follow the instructions contained in this manual may cause injury or damage to the Equipment and will void the warranty.

Retain this Operator's Manual for future reference.

Check with www.nemco.com for updates and new versions of your Operator's Manual.

SHIPPING DAMAGE CLAIM INSTRUCTIONS

If shipping damage to the Equipment is discovered or suspected, observe the following guidelines in preparing a shipping damage claim:

1. Write down a description of the damage or the reason for suspecting damage as soon as it is discovered. This will help in filling out the claim forms later.
2. As soon as damage is discovered or suspected, notify the carrier that delivered the shipment.
3. Arrange for the carrier's representative to examine the damage.
4. Fill out all carrier claims forms and have the examining carrier sign and date each form.



WARNING: Improper installation, adjustment, alteration, service or maintenance can cause property damage, injury or death. Read the Operator's Manual and Service Manual thoroughly before installing or servicing this equipment.



WARNING: Do not operate damaged Equipment. Operating damaged equipment can cause property damage, injury or death.

IMPORTANT SAFETY RULES



WARNING: Read all instructions. Failure to follow all instructions listed below may result in electric shock, fire and/or serious injury. The term “Equipment” in all of the warnings listed below refers to your Fried Food Holder.

SAVE THESE INSTRUCTIONS FOR FUTURE REFERENCE.

When using electrical appliances, basic safety precautions should always be followed to reduce the risk of fire, electric shock, and/or injury to persons including the following:

WORK AREA

- **Keep work area clean and well lit.** Cluttered or dark areas can increase the likelihood of accidents.
- **Do not set liquids on or near Equipment.** Liquids entering Equipment will increase the risk of electric shock.
- **Do not cover Equipment or stack other objects on top of Equipment.** Unintended items on Equipment can increase the risk of fire.
- **Do not use Equipment outdoors.** Outdoor conditions can increase the risk of electrical shock.
- **Do not place Equipment on or near a hot gas or electric burner or in a heated oven.** This creates an increased risk of fire and electric shock.

ELECTRICAL SAFETY

- **Equipment plugs must match the outlet. Never modify the plug in any way. Do not use any adapter plugs.** Modified plugs and non-matching outlets will increase the risk of electric shock.
- **Avoid body contact with earthed or grounded surfaces such as pipes, radiators, ranges, refrigerators and other foodservice equipment.** There is an increased risk of electric shock if your body is earthed or grounded.
- **Do not expose Equipment to wet conditions. Do not immerse cord, plug or Equipment in water or other liquids.** Water or other liquids entering Equipment will increase the risk of electric shock.
- **Do not abuse the cord. Do not yank cord to disconnect from power outlet. Never use the cord for carrying, pulling or unplugging the Equipment. Keep cord away from heat, oil, sharp edges, moving parts or the edge of table or counter.** Damaged or entangled cords increase the risk of electric shock.

FOOD SAFETY

- **Equipment must be operated with insert pan and air filter.** Equipment is design to hold fried and other foods for an extended time period when used with insert pan and air filter.
- **Extended food hold time for up to around 30 minutes.** Equipment is designed for temporary extended food holding.

EQUIPMENT USE AND CARE

- **Stay alert, watch what you are doing and use common sense when using Equipment. Do not use Equipment while you are tired or under the influence of drugs, alcohol or medication.** A moment of inattention while operating Equipment may result in serious personal injury.
- **Avoid touching hot metal parts. Do not stand or sit in Equipment.** This could result in serious personal injury including burns.
- **This Equipment is not intended for use by persons with reduced physical, sensory or mental capacities. Do not allow persons unfamiliar with the Equipment or these instructions to operate the Equipment.** Use of Equipment by such persons could result in hazardous situation.
- **Do not overreach. Keep proper footing and balance at all times.** This enables better control of the Equipment in unexpected conditions.
- **Do not use the Equipment if the switch does not turn it on or off.** Any Equipment that cannot be controlled with the switch is dangerous and must be repaired.
- **Disconnect the plug from the power source before make any adjustment or cleaning the Equipment.** This may result in increased risk of electric shock.
- **Do not use any accessory or attachment not recommended by Meister Cook. Do not operate Equipment on its side or inverted. Do not introduce foreign objects into Equipment.** Use of Equipment other than intended could result in a hazardous situation.
- **Maintain the Equipment. Check for breakage of cords, plugs and other parts that may affect the Equipment's operation. If damaged, have the Equipment repaired before use.** Many accidents are caused by poorly maintained Equipment.
- **Use the Equipment in accordance with these instructions and in the manner intended, taking into account the working conditions and work to be performed.** Use of the Equipment for operations different from those intended could result in a hazardous situation.

SERVICE

- **Have Equipment serviced by a qualified repair person using only identical replacement parts.** This will ensure that the safety of the Equipment is maintained.
- **When servicing equipment, use only identical replacement parts. Follow instructions in the Maintenance section in this manual.** Use of unauthorized parts or failure to follow Maintenance instructions may create a risk of shock or injury.

EXTENSION CORD INSTRUCTIONS

Make sure that an extension cord has the capacity to handle the current the Equipment will draw. An undersized extension cord will cause a drop in line voltage, resulting in overheating and loss of power. The minimum recommended American Wire Gauge (A.W.G.) for an electric cord up to 6' is 18 AWG and 16 AWG for electrical cord length over 6'. Consult with extension cord manufacturer before use. Only round jacketed cords listed by Underwriter's Laboratories (UL) shall be used. Before using any extension cord, inspect it for loose or exposed wires and cut or worn insulation. Do not attempt to modify the electric plug or electric cord in any way.



WARNING: Keep the extension cord clear of the working area. Position the electric cord so that it will not get caught on other equipment or interfere in work space. Failure to do so can result in serious personal injury.



WARNING: Check extension cords before each use. If damaged, replace immediately. Never use Equipment with a damaged cord since touching the damaged area could cause electrical shock resulting in serious injury.

SITE PREPARATION and INSTALLATION

These instructions must be retained by the owner/user for future reference.

This Equipment is built to comply with applicable standards for manufacturers, including approval agencies, such as UL, NSF, CSA, ETL, and others. Many local codes exist, and it is the responsibility of the owner and installer to comply with these codes.

Check the electrical rating label to ensure that the Equipment is connected to the correct voltage, phase, amperage and wattage that are stated on the Equipment's identification label. The identification label is located on the control panel plate of the Equipment. A secondary label is included inside the Equipment behind the control panel plate. This Equipment should be connected to a power supply that is 120 volts, 60 Hz, AC only. Do not operate on direct current (DC). A substantial voltage drop will cause a loss of power and the Equipment will overheat. If the Equipment does not operate when plugged into an outlet, check the power supply.

Observe all clearance requirements to provide air supply for proper operation, as well as sufficient clearance for servicing. Keep the area around the Equipment free and clear of combustibles. Dimensions and clearance specifications are shown under "Specifications for 6075" and "Clearances Requirements for 6075".



WARNING: The installation and connection must comply with national and local electrical codes. Ensure electrical supply conforms with electrical characteristics shown on the identification label. All services must be performed by a qualified technician.



CAUTION: The operator of this Equipment is solely responsible for ensuring safe holding temperature levels for all food items. Failure to do so could result in unsafe and unhealthy food products for customers.

CLEARANCE REQUIREMENTS for 6075

This Equipment must be installed in accordance with the following clearances in order to provide proper operation and servicing of the appliance. Also, it is recommended that the Equipment be installed with sufficient clearances to provide proper cleaning and maintenance.

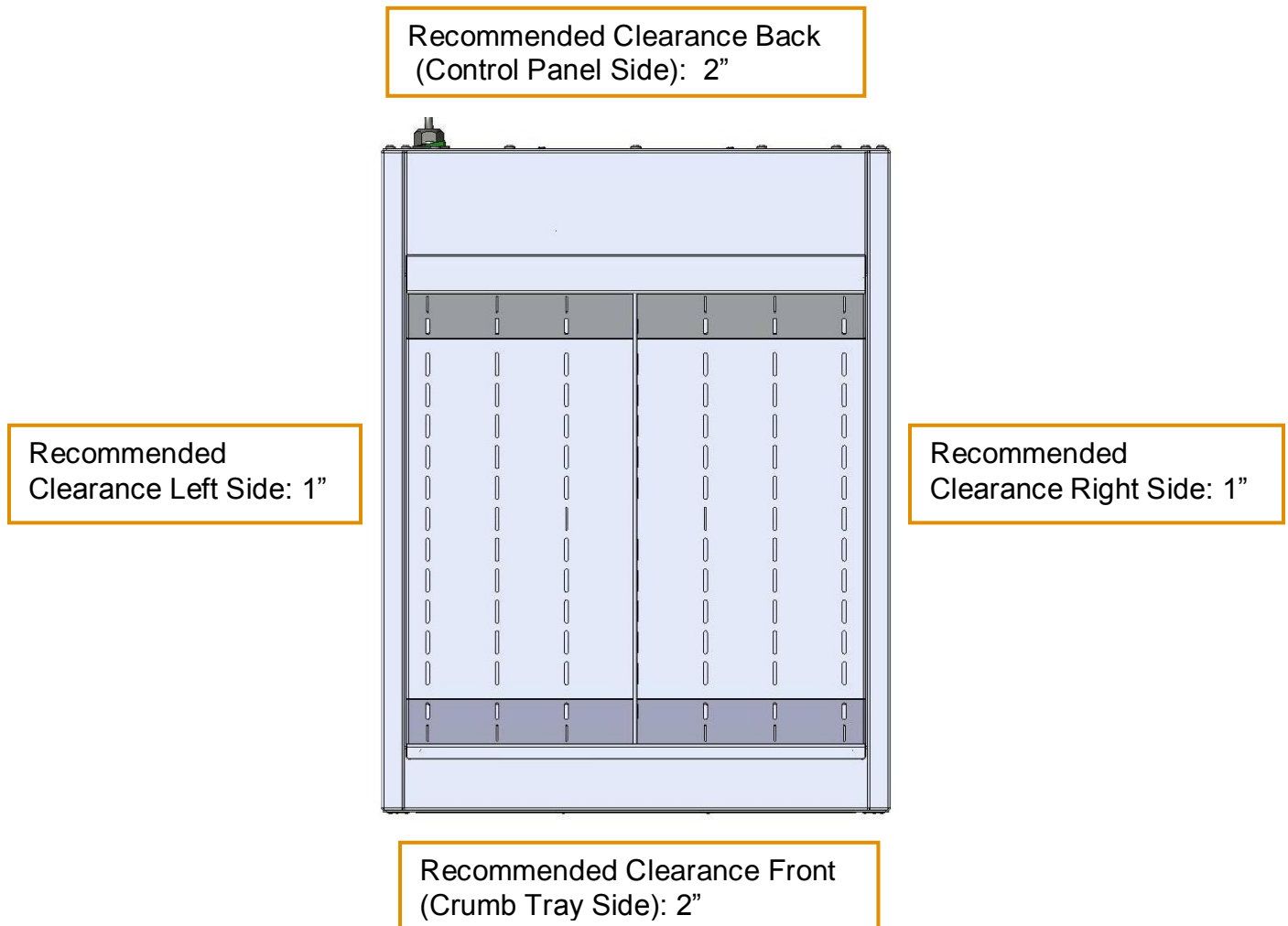

Recommended Clearances:
Front 2", Back 2", Left 1", Right 1"

OPERATING INSTRUCTIONS

The NEMCO ThermalPRO Fried Food Holder was designed to optimize the holding time for all fried foods with a combination of hot air convection air from the air outlet port and radiant heat from the bottom of the pan insert. The convection air flow volume and velocity as well as the radiant air temperature has been optimized and preset for optimum holding time for all fried foods. Therefore, no adjustment of airflow or temperature is necessary or required.

OPERATION:

- Step 1: Verify that air filter is installed properly.
- Step 2: Verify that insert pan is installed properly.
- Step 3: Adjust pan divider at desired location.
- Step 4: Turn power rocker switch to the ON position. "I" = ON, "O" = OFF.
- Step 5: Allow for a 35-minute preheat.



WARNING: Do not use any attachment or accessories not recommended by Meister Cook. The use of attachments or accessories not recommended by Meister Cook can result in serious personal injury

CLEANING AND MAINTENANCE

It is **IMPORTANT** to follow cleaning and maintenance instructions and procedures to ensure satisfactory performance of your Fried Food Holder. Neglecting these instruction and procedures may result in reduced fried food holding times, reduced performance and reliability and may void the warranty.



CAUTION: Allow the Equipment to cool down sufficiently before performing any cleaning or maintenance procedures. Failure to do so could result in personal injury to employees and operators.



WARNING: Disconnect power supply before cleaning Equipment. Failure to do so could result in serious personal injury

DAILY CLEANING

- Step 1: After completion of the last fried food holding cycle of the day, unplug Equipment.
- Step 2: Remove the pan insert, the pan divider, the crumb tray and the air filter.
- Step 3: Wash pan insert, pan divider, crumb tray and air filter with soapy water. Ensure that

all grease particles and food crumbs are removed. Ensure that the air filter is clean and free.

Step 4: Use a soft cloth, dampened with warm soapy water, to clean the inside (pan insert area) and outside walls of the Fried Food Holder. Airflow openings should be inspected and any blockage should be removed.

Step 5: Install air filter, pan insert, pan divider, and crumb tray.



CAUTION: Do not flood the Equipment with cleaning fluids, water or other liquids. Do not allow any fluids to enter the Equipment through the air inlet or air outlet port. It will damage the Equipment.

TROUBLESHOOTING GUIDE

Problem	Probable Cause	Corrective Action
Equipment doesn't operate	No Power: Power Plug not plugged in	Plug in Power Plug
	Insufficient power supply to equipment	Check power source for proper voltage. Check if power is provided by power outlet.
	Reset-Breaker switch tripped	Reset reset-breaker switch on control panel. If breaker switch continues to trip, replace switch
	Broken On/Off Switch	Replace On/Off Switch
Excessive time to reach temperature	Insufficient power supply to equipment	Verify voltage
Low Air Volume	Improper voltage	Verify voltage
	Air Inlet Port blocked	Remove blockage
Some heat, but no air flow and green indicator light on	Crossflow blower failure	Replace crossflow blower
Cold air flow, but no heat and green indicator light on	Heater failure	Replace heater

PARTS AND WARRANTY SERVICE

For parts please contact PartsTown at:

For **Parts and Warranty Service** call:



Give us a call! (800) 438-8898

Personal service and same-day
shipping until 7pm EST



WARNING: When servicing use only identical replacement parts. Use of any other parts may create a hazard or cause product damage.



WARNING: Have Equipment serviced by a qualified repair person. This will ensure that the safety of the Equipment is maintained.

PARTS IDENTIFICATION

Please contact PartsTown at (800) 438-8898 or www.partstown.com for replacement parts. Please make sure to have the correct part number ready when ordering parts.

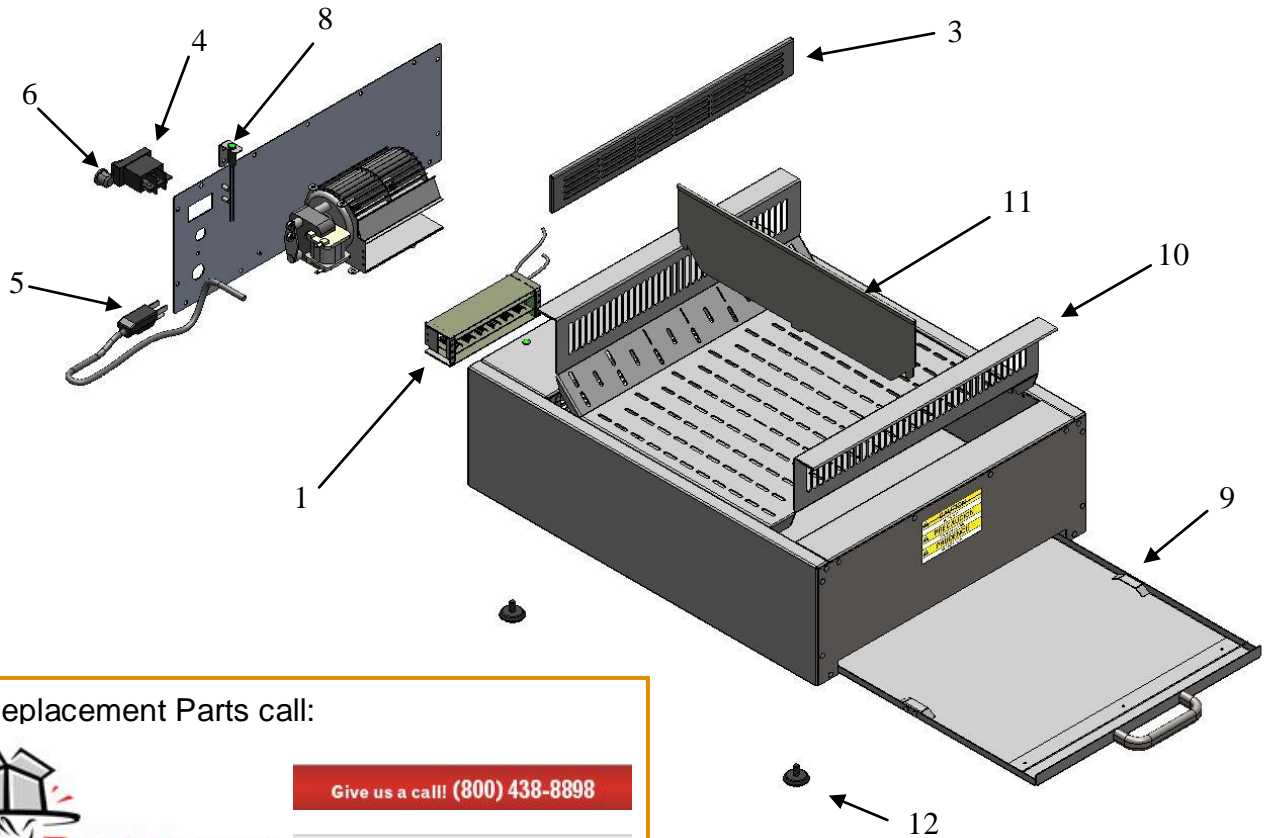

For Replacement Parts call:



PartsTOWN
Your order's always up

Give us a call! (800) 438-8898

Personal service and same-day
shipping until 7pm EST

(not all components shown)

#	Part Description	Part Number
1	Heater Assembly 750 Watt, Includes Blower	49680
3	Air Filter	49679
4	On/Off Switch	49771
5	Power Cord	46751
6	15 Amp Reset Fuse (with Spash Guard Boot)	49779
8	Power Status LED Assembly	49777
9	Crumb Tray Assembly	70241
10	Food Insert Pan	70246
11	Food Insert Divider	70254
12	Leveling Mount	46927